



Quick Start Guide

Step 3: Wire up the green mounting block to the colored wires. These are your stations/zones

Step 4: Wire up the common (typically white) to the wire that was connected to the common

Use the photo of the wiring you took earlier to help identify each zone quickly

If **Ethernet cable** is used for Internet, please Plug-in Ethernet cable to RJ-45 port. (Ethernet Internet connection only available for HWN12-200).

Turn power off AND on 5 sec. later. Internet Green Light would be on several min. soon.

Then go **Register** directly



As using **WiFi**, please make sure your smartphone or tablet is on your Wi-Fi Network.

Step 8: Connect to Wi-Fi. Touch the “Start” Butt on

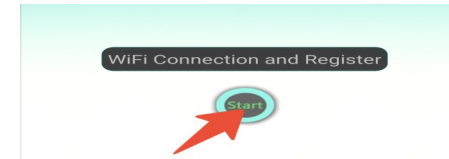

Step 9: Check the router name or just : **Wi-Fi** (iOS 13). Nxeco controller only works to 2.4G Wi-Fi router. Enter in your Wi-Fi Password . Use “Show Password” to verify your password is entered in correctly



Please follow the steps on APP !

Step 12: Push “Ok”

Please wait several min. and be patient... The first time internet connection may take 10 min. after blue light on



After green light of controller on, the controller has been linked to Nxeco server. Go to register steps !

Step 13: Touch “Skip to Register”

Step 14: Touch Register Controller

Step 15: Touch “Yes” when app displays

“New Controller Found, Continue to Register?”

Step 16: After “Register Successful”, prepare to mount in Nxeco controller at proper location

Thank you for purchasing a Nxeco Smart Weather-based Irrigation Controller! Please follow the steps to make installation a breeze.

Step 1: Remove your existing controller



Snap a photo of existing wiring and corresponding zones to take out the guess work!

Step 2: Remove the green and white mounting blocks from your Nxeco Controller.

Step 5: Download the Nxeco App from Google Play or the Apple App Store

Step 6: Open the app and sign up for an account



You must activate your account with the email received from Nxeco. Check your email and your spam folder for the Nxeco verification email

Step 7: Plug in the controller near your router.



This is only to help the controller access your Wi-Fi password, once your Nxeco controller is on your Wi-Fi network, it will maintain a connection over a much longer distance

Step 7: Start up the Nxeco App and log in using the email and password you provided earlier

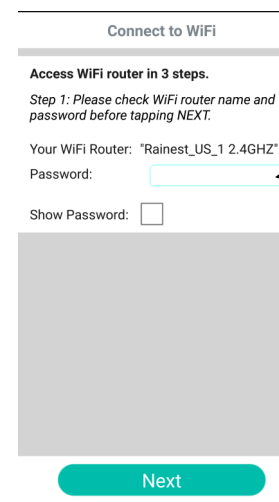

Enter password here

Step 10: Press Next

Push and hold Smart Wi-Fi Button on the controller until the blue light flashes quickly.

Then release before touching “Apply”

Step 11: Wait until blue “Wi-Fi” light and green “Internet” light are on

Step 17: Secure controller to wall using the included anchors and screws

Step 18: Connect the terminal blocks to the controller and match the colors.

Step 19: Plug in the controller into the wall using the included transformer.

Step 20: Turn the dial to “Watering Now”

Step 21: Push the “+” and “Start” for each connected zone to verify wiring is correct

Congratulations! Turn the dial to “Auto Run” then turn this sheet over and let’s program your watering schedule



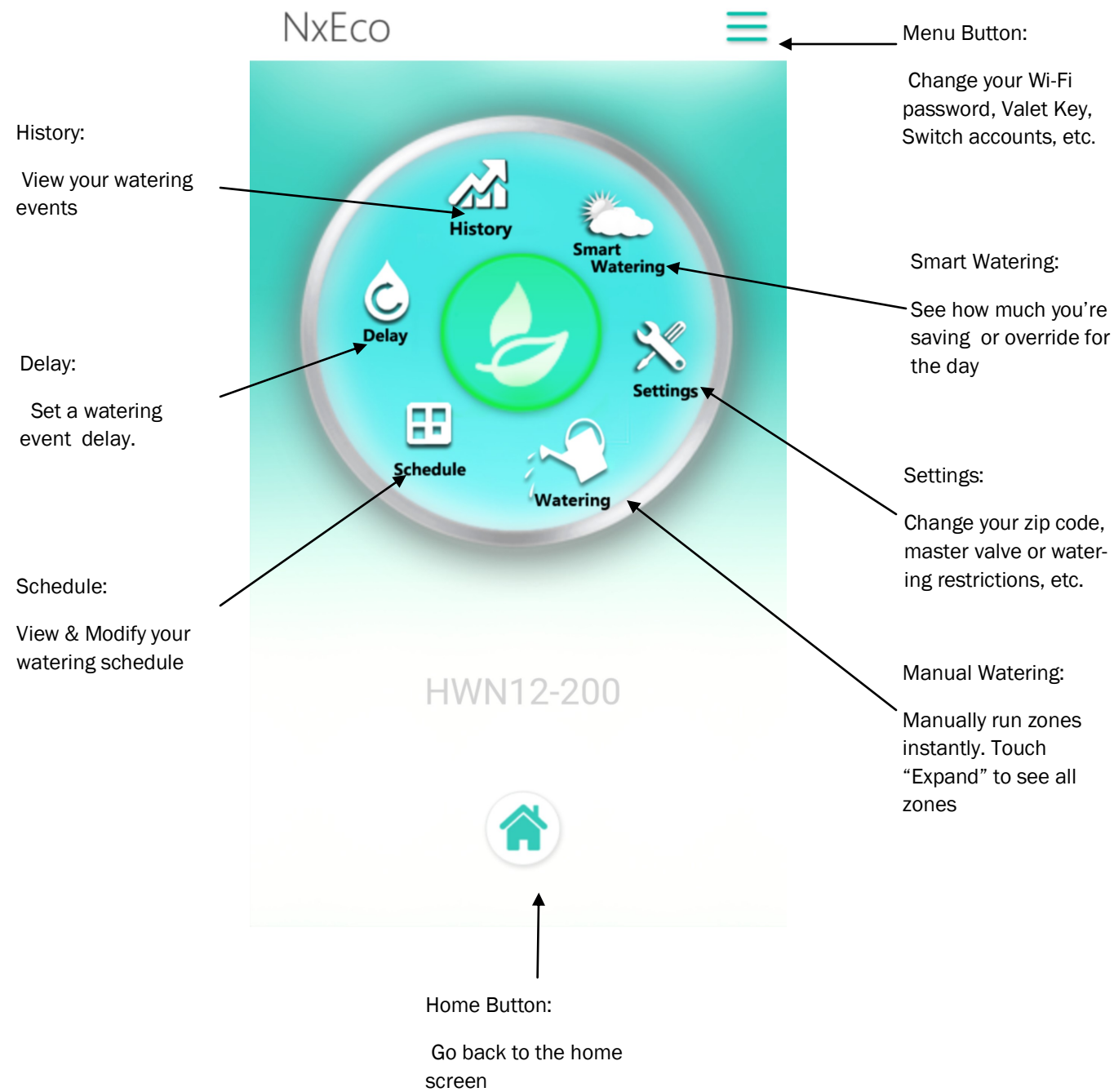

Touch the center leaf to get instant status updates!

How to Setup a Schedule

Step 1: Touch the Schedule Icon

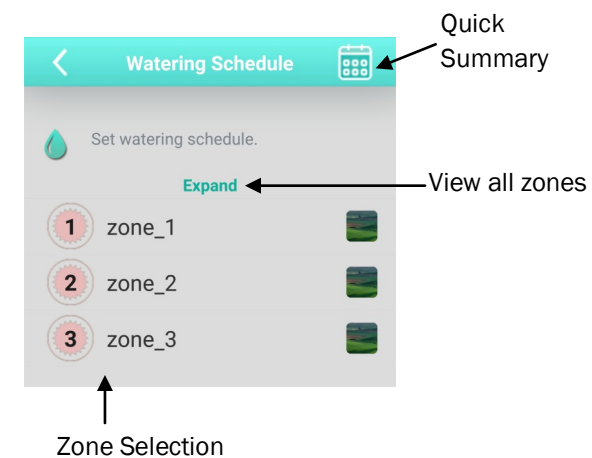

Program A, Program B, Program C and Program D allow you to save different programs for different seasons.

Advanced Feature How to Override Smart Watering

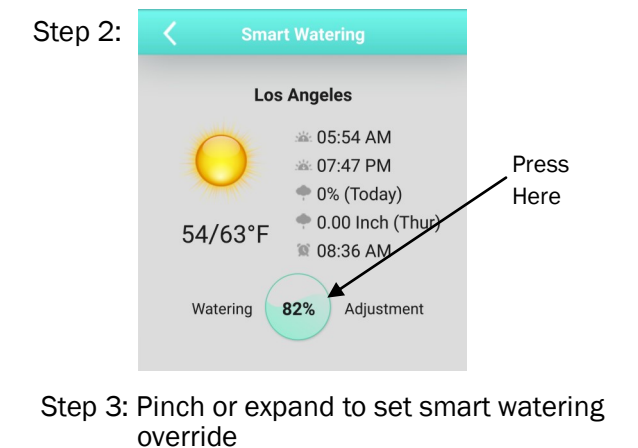

When the green "Smart Watering" circle turns blue, Smart Watering has been manually changed

How to Setup a Schedule

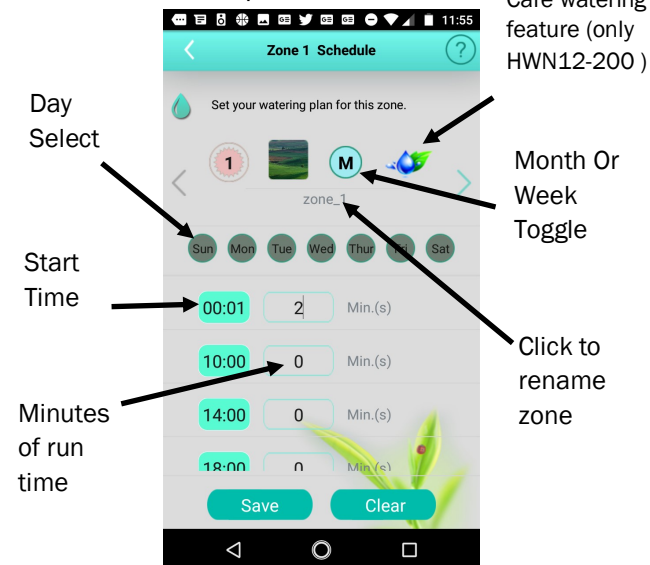

Always touch the "Save" button before going to the next station/zone

Advanced Feature How to Use a Valet Key

Step 1: Touch the Menu button
 Step 2: Select "Valet Keys"
 Step 2: Press the "+" icon at the bottom
 Step 3: Enter in the email address of the person you want to authorize then press "Save"
 Caution: Your authorized user must have a Nxeco Account

The person with your valet key will have to touch the menu button then select "Account Switch" to access your controller

Nxeco

(949)813-7909
 support@nxeco.com
 Copyright 2017 Nxeco, Inc.